



MM[®] Pyro-Flex / BPF Series

Below Slab Fire Barrier Protection System

DESCRIPTION

The Below Slab Pyro-Flex Fire Barrier Protection System is the market's first below the slab fire barrier system. Pyro-Flex is an engineered high-performance fire resistive system for sealing expansion joint openings. The system is comprised of a flexible, high purity ceramic fiber blanket, stainless steel foil and a matrix of fire resistive cloth as required to achieve a specified protection and endurance rating. System is secured directly to the underside of the expansion joint opening.

BASIC USE

BPF is a fire resistive sealing system designed for sealing expansion joint openings in parking structures, buildings and other structures exposed to exterior weather conditions.

PERFORMANCE STANDARDS

- UL 2079-Class I, II and III
- ASTM E-119 / E-1966 / E-1399
- L-Rating = 0 SCFM/LF

CODE COMPLIANCE

- UBC, SBC, BOCA, CAN-S101
- International Building Code

FEATURES

- Provides the required fire endurance rating of 2 and 3 hours.
- For joints widths up to 48" wide.
- Listed with an accredited independent laboratory.
- Designed for below slab mounting when top-down and under-slab fire barrier types are not an option due to concrete deck design.
- Accommodates dynamic movement without stress or degradation to its components.
- Minimizes passage of smoke.

SPECIAL FEATURES

- Design compatible with most expansion joints and no underside cover is required.
- Non-permeable materials double as integral smoke barrier.
- Accommodates seismic lateral shear.

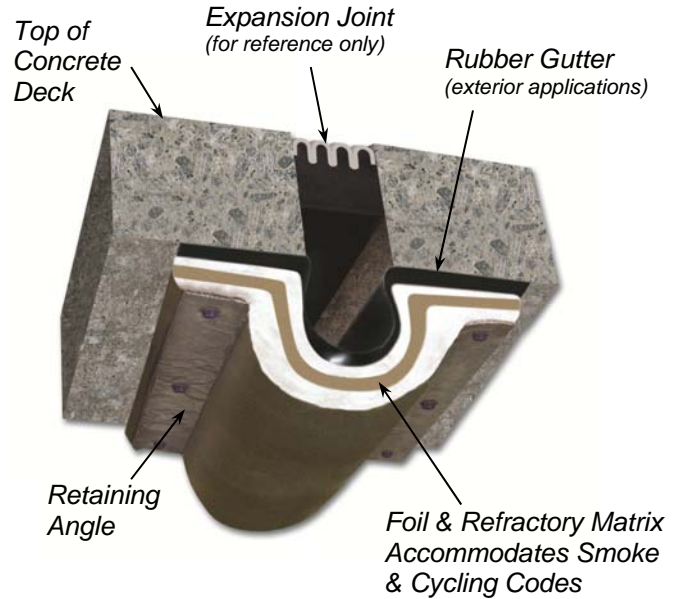

Thermal, Seismic & Shear Movement Designs Available

PACKAGING

Pyro-Flex supplied in 12.5-foot lengths shipped on wooden pallets or cardboard cartons.

Metal retainers supplied in 10-foot lengths shipped on wooden pallets or cardboard cartons.

Hardware and other accessories packaged in cardboard cartons.

STORAGE & PROTECTION

All materials should be stored in a completely dry location prior to use. Fire Barrier must be kept dry before, during and after installation.

LIMITATIONS

- Expansion joint openings must be parallel and straight to achieve fire-resistive seal.
- Adjacent construction must have fire-resistive ratings equal to or greater than the rating of the fire barrier systems.

PRECAUTIONS

Use protective goggles and gloves. Read and follow labels and Material Safety Data Sheet before use.

MM[®] Pyro-Flex / BPF Series

SELECTION GUIDE

2 Hour Rated Model Numbers	Total Movement		Joint Opening "A"					
			Minimum		Nominal		Maximum	
BPF-2048F-SC 2-1	2.0	51	1.0	25	2	51	3.00	76
BPF-2048F-SC 2.5-1.25	2.5	64	1.25	25	2.5	64	3.75	96
BPF-2048F-SC 3-1.5	3.0	76	1.5	38	3	76	4.50	114
BPF-2048F-SC 4-2	4.0	102	2.0	51	4	102	6.00	152
BPF-2048F-SC 5-2.5	5.0	127	2.5	64	5	127	7.50	191
BPF-2048F-SC 6-3	6.0	152	3.0	76	6	152	9.00	229
BPF-2048F-SC 8-4	8.0	203	4.0	102	8	203	12.0	305
BPF-2048F-SC 10-5	10.0	254	5.0	127	10	254	15.0	381

Contact MM Systems for larger sizes and project specific designs.
 3 Hour Rated Listings are available. Example designation is BBF-3048F-SC 2-1.
 BPF Series requires an expansion joint or cover over the fire barrier.

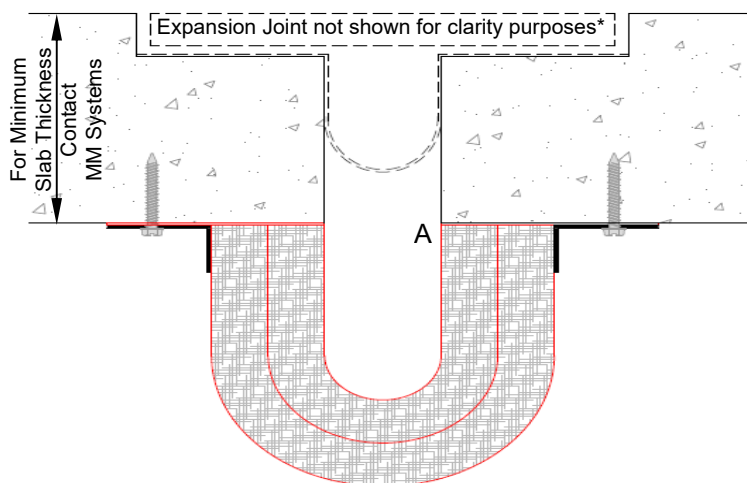

Below Slab Pyro-Flex Series

*surface expansion joint or cover plate required

INSTALLATION

1. Remove and repair all unsound concrete in and around the joint opening. All spalls must be repaired with compatible patching material.
2. Uncoil fire barrier and fold into a "U" shape configuration.
3. Install fire barrier into underslab expansion joint opening.
4. Attach metal retaining angles.
5. Install anchors at specified intervals.
6. Refer to the BPF Installation Guideline for detailed step-by-step instructions.

LIMITED WARRANTY

MM Systems warrants the Pyro-Flex Fire Barrier System to be free of defects in material and conform to technical data listed. We make no warranty as to color or appearance. Since methods of application can affect performance and on-site conditions are beyond our control, MM Systems makes no other warranty, expressed or implied, including warranties of MERCHANTABILITY AND FITNESS FOR A PARTICULAR PURPOSE. MM Systems sole obligation shall be, at its option, to replace, or to refund the purchase price of the quantity of system proved to be defective. In no event shall MM Systems be liable for any special, incidental, consequential, loss of profits or punitive damages. Other warranties may be available when installed by a MM Certified Contractor.

TESTING COMPLIANCE

1. Certified and listed by an accredited third-party witnessing agency.
2. Tested in accordance with International Building Code Section 712.3, ASTM E1966 and UL 2079 at a maximum listed expansion joint opening as defined by ASTM E1399.
3. Minimizes passage of smoke.
4. Tested with positive pressure.
5. Cycle tested full length incorporating splice transitions. Pyro-Flex fire barrier system meets or exceeds the following dynamic movement requirements (cpm equals cycles per minute):
 - a. Seismic movement rating of 30 (cpm) for 100 cycles, followed by;
 - b. Thermal movement rating of 10 (cpm) for 400 cycles.
 - c. Total Cycles Required - 500 cycles.

MM Systems reserves the right to amend or withdraw information contained herein, without notice, and will not be liable for any inaccuracy or ambiguity of said information.

Current Issue 1-28-19

