

Model Number	Nominal (JO <sub>N</sub> )		Slide Plate Width (SW <sub>N</sub> )		Thermal Movement (JO <sub>T</sub> )				Seismic Movement (JO <sub>S</sub> )				Total (JO <sub>T</sub> ) Movement	
	Minimum	Maximum	Minimum	Maximum	Minimum	Maximum	Minimum	Maximum	Minimum	Maximum	Minimum	Maximum	Minimum	Maximum
SSC-C-250-P	<b>1.50</b>	8	<b>4.625</b>	117	<b>0.75</b>	19	<b>2.50</b>	64	<b>0.75</b>	19	<b>3.25</b>	83	<b>2.50</b>	64
SSC-C-350-P	<b>2.00</b>	57	<b>5.625</b>	143	<b>1.00</b>	25	<b>3.50</b>	89	<b>1.00</b>	25	<b>4.25</b>	108	<b>3.25</b>	83
SSC-C-450-P	<b>3.00</b>	76	<b>6.875</b>	175	<b>1.50</b>	38	<b>4.50</b>	114	<b>1.50</b>	38	<b>5.50</b>	140	<b>4.00</b>	102
SSC-C-550-P	<b>4.00</b>	102	<b>7.875</b>	200	<b>1.50</b>	38	<b>5.50</b>	140	<b>1.50</b>	38	<b>6.50</b>	165	<b>5.00</b>	127

Dimension shown in inches (bold) and millimeters. JO = Joint Opening. SL = Sight Line. Color Options for rubber seals are Black or Special Order Gray.

**Waterproofing Membrane Compatibility** - confirm with membrane manufacturer grade of rubber to be used on waterproofing splice flap.

**Elevation Tolerance** - Surface areas two feet on each side of the expansion joint opening shall have identical elevations creating flush slab-to-slab transition.

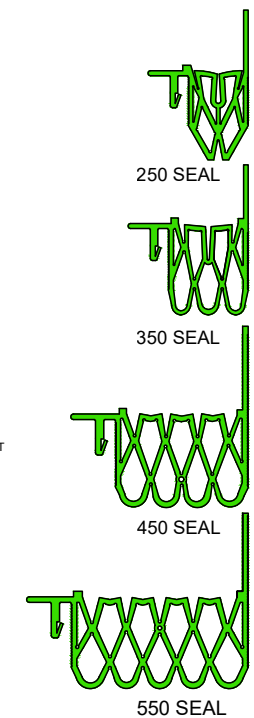
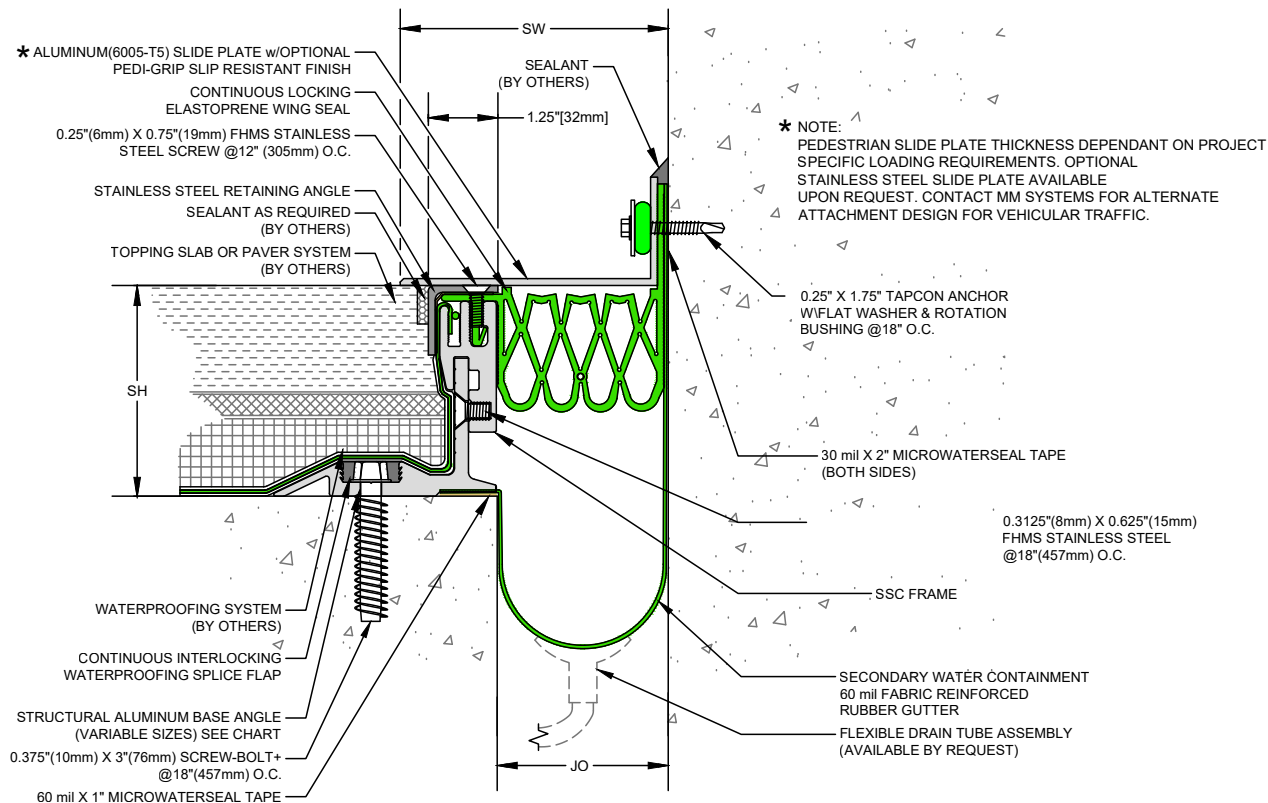

Base Angle Size	System Height (SH)	
<b>3.5 x 1.75</b>	<b>See Next Page</b>	
<b>3.5 x 2</b>	<b>3.25</b>	<b>83</b>
<b>3.5 x 2.25</b>	<b>3.5</b>	<b>89</b>
<b>3.5 x 2.5</b>	<b>3.75</b>	<b>95</b>
<b>3.5 x 2.75</b>	<b>4</b>	<b>102</b>
<b>3.5 x 3</b>	<b>4.25</b>	<b>108</b>
<b>3.5 x 3.25</b>	<b>4.5</b>	<b>114</b>
<b>3.5 x 3.5</b>	<b>4.75</b>	<b>121</b>
<b>3.5 x 3.75</b>	<b>5</b>	<b>127</b>
<b>3.5 x 4</b>	<b>5.25</b>	<b>133</b>
<b>3.5 x 4.25</b>	<b>5.5</b>	<b>140</b>
<b>3.5 x 4.5</b>	<b>5.75</b>	<b>146</b>
<b>3.5 x 4.75</b>	<b>6</b>	<b>152</b>

**SSC-C Series Expansion Joint**  
 (Slab-to-Wall)



50 MM WAY  
 PENDERGRASS, GA. 30567  
 706-824-7500 PHONE  
 800-241-3460 TOLL FREE  
 706-824-7501 FAX

[www.mm-usa.com](http://www.mm-usa.com)

For Spec-Data, Install Guides and other data visit [www.mm-usa.com](http://www.mm-usa.com)

**RIGHTS OF DESIGN**

All rights of design, detail, engineering and/or invention contained herein are the property of MM Systems Corporation and hereby reserved and are not to be reproduced or provided to any other party. MM Systems Corporation reserves the right to amend or withdraw any information contained herein without notice and will not be liable for any inaccuracy or ambiguity of said information.

**Split Slab Covered Membrane Expansion Joint**  
**SSC-C Pedestrian Series**

Drawn by: <b>DMW</b>	Scale: <b>NTS</b>	Drawing Number: <b>41250-02</b>
SHT. 1 OF 4	Issue Date: <b>02-13-2019</b>	

Model Number	Nominal (JO <sub>n</sub> )		Slide Plate Width (SW <sub>n</sub> )		Thermal Movement (JO <sub>t</sub> )		Seismic Movement (JO <sub>s</sub> )		Total (JO <sub>t</sub> ) Movement			
	Minimum	Maximum	Minimum	Maximum	Minimum	Maximum	Minimum	Maximum	Minimum	Maximum		
SSC-C-250-P	<b>1.50</b>	8	<b>4.625</b>	117	<b>0.75</b>	19	<b>2.50</b>	64	<b>0.75</b>	19	<b>3.25</b>	83
SSC-C-350-P	<b>2.00</b>	57	<b>5.625</b>	143	<b>1.00</b>	25	<b>3.50</b>	89	<b>1.00</b>	25	<b>4.25</b>	108
SSC-C-450-P	<b>3.00</b>	76	<b>6.875</b>	175	<b>1.50</b>	38	<b>4.50</b>	114	<b>1.50</b>	38	<b>5.50</b>	140
SSC-C-550-P	<b>4.00</b>	102	<b>7.875</b>	200	<b>1.50</b>	38	<b>5.50</b>	140	<b>1.50</b>	38	<b>6.50</b>	165

Dimension shown in inches (bold) and millimeters. JO = Joint Opening. SL = Sight Line. Color Options for rubber seals are Black or Special Order Gray.

**Waterproofing Membrane Compatibility** - confirm with membrane manufacturer grade of rubber to be used on waterproofing splice flap.

**Elevation Tolerance** - Surface areas two feet on each side of the expansion joint opening shall have identical elevations creating flush slab-to-slab transition.

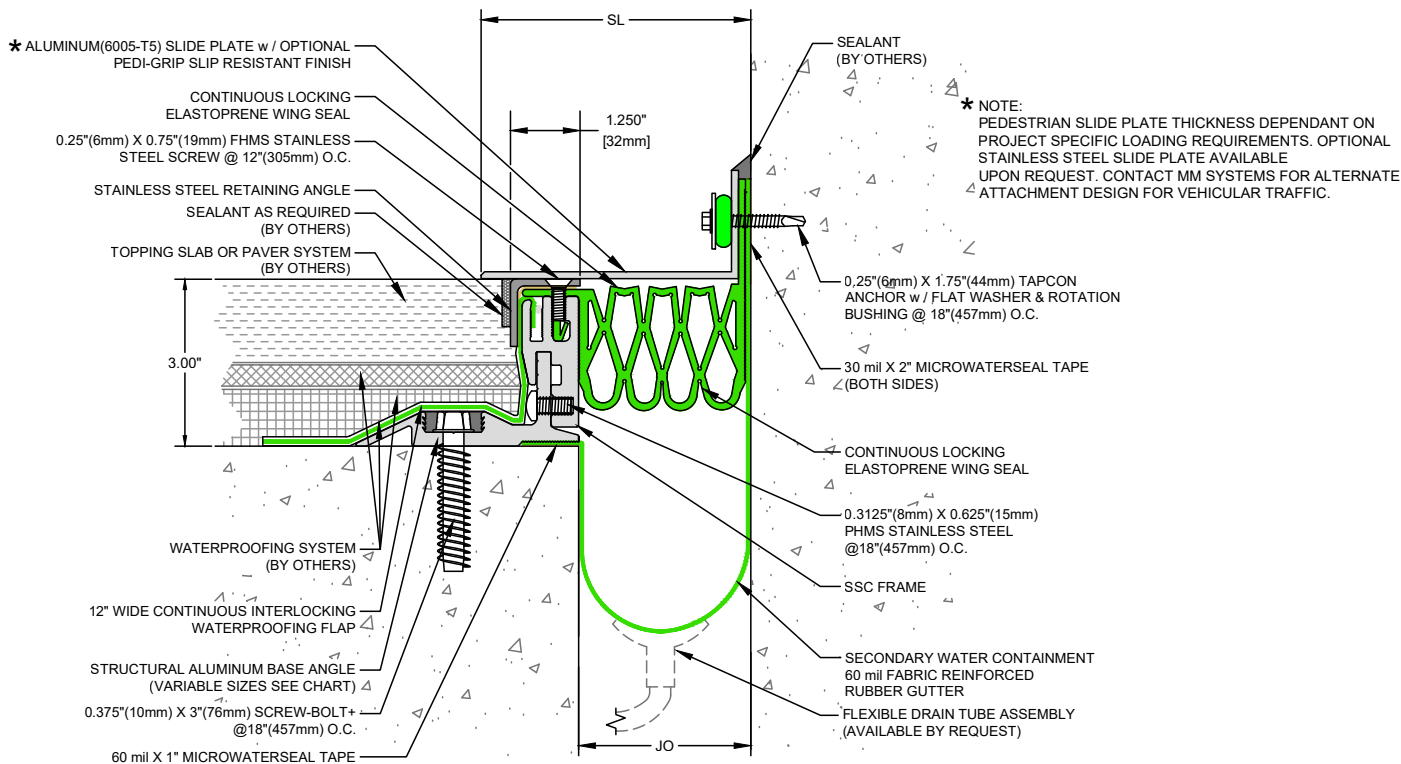

**SSC-C Series Expansion Joint / 3" System Height**  
(Slab-to-Wall)

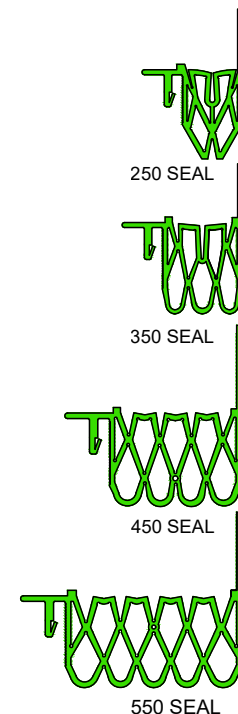

Base Angle Size	System Height (SH)	
<b>3.5 x 1.75</b>	<b>See Next Page</b>	
<b>3.5 x 2</b>	<b>3.25</b>	<b>83</b>
<b>3.5 x 2.25</b>	<b>3.5</b>	<b>89</b>
<b>3.5 x 2.5</b>	<b>3.75</b>	<b>95</b>
<b>3.5 x 2.75</b>	<b>4</b>	<b>102</b>
<b>3.5 x 3</b>	<b>4.25</b>	<b>108</b>
<b>3.5 x 3.25</b>	<b>4.5</b>	<b>114</b>
<b>3.5 x 3.5</b>	<b>4.75</b>	<b>121</b>
<b>3.5 x 3.75</b>	<b>5</b>	<b>127</b>
<b>3.5 x 4</b>	<b>5.25</b>	<b>133</b>
<b>3.5 x 4.25</b>	<b>5.5</b>	<b>140</b>
<b>3.5 x 4.5</b>	<b>5.75</b>	<b>146</b>
<b>3.5 x 4.75</b>	<b>6</b>	<b>152</b>



50 MM WAY  
PENDERGRASS, GA. 30567  
706-824-7500 PHONE  
800-241-3460 TOLL FREE  
706-824-7501 FAX

[www.mm-usa.com](http://www.mm-usa.com)

For Spec-Data, Install Guides and other data visit [www.mm-usa.com](http://www.mm-usa.com)

**RIGHTS OF DESIGN**

All rights of design, detail, engineering and/or invention contained herein are the property of MM Systems Corporation and hereby reserved and are not to be reproduced or provided to any other party. MM Systems Corporation reserves the right to amend or withdraw any information contained herein without notice and will not be liable for any inaccuracy or ambiguity of said information.

**Split Slab Covered Membrane Expansion Joint**  
**SSC-C Pedestrian Series 3" System Height**

Drawn by: <b>DMW</b>	Scale: <b>NTS</b>	Drawing Number: <b>41250-02</b>
SHT. 2 OF 4	Issue Date: <b>02-13-2019</b>	

Model Number	Nominal (JO <sub>n</sub> )		Slide Plate Width (SW <sub>n</sub> )		Thermal Movement (JO <sub>t</sub> )				Seismic Movement (JO <sub>s</sub> )				Total (JO <sub>t</sub> )	
	Minimum	Maximum	Minimum	Maximum	Minimum	Maximum	Minimum	Maximum	Minimum	Maximum	Minimum	Maximum	Minimum	Maximum
SSC-C-250-V	<b>1.50</b>	8	<b>5.000</b>	127	<b>0.75</b>	19	<b>2.50</b>	64	<b>0.75</b>	19	<b>3.25</b>	83	<b>2.50</b>	64
SSC-C-350-V	<b>2.00</b>	57	<b>6.000</b>	152	<b>1.00</b>	25	<b>3.50</b>	89	<b>1.00</b>	25	<b>4.25</b>	108	<b>3.25</b>	83
SSC-C-450-V	<b>3.00</b>	76	<b>7.000</b>	178	<b>1.50</b>	38	<b>4.50</b>	114	<b>1.50</b>	38	<b>5.50</b>	140	<b>4.00</b>	102
SSC-C-550-V	<b>4.00</b>	102	<b>8.000</b>	203	<b>1.50</b>	38	<b>5.50</b>	140	<b>1.50</b>	38	<b>6.50</b>	165	<b>5.00</b>	127

Dimension shown in inches (bold) and millimeters. JO = Joint Opening, SL = Sight Line. Color Options for rubber seals are Black or Special Order Gray.  
**Waterproofing Membrane Compatibility** - confirm with membrane manufacturer grade of rubber to be used on waterproofing splice flap.  
**Elevation Tolerance** - Surface areas two feet on each side of the expansion joint opening shall have identical elevations creating flush slab-to-slab transition.

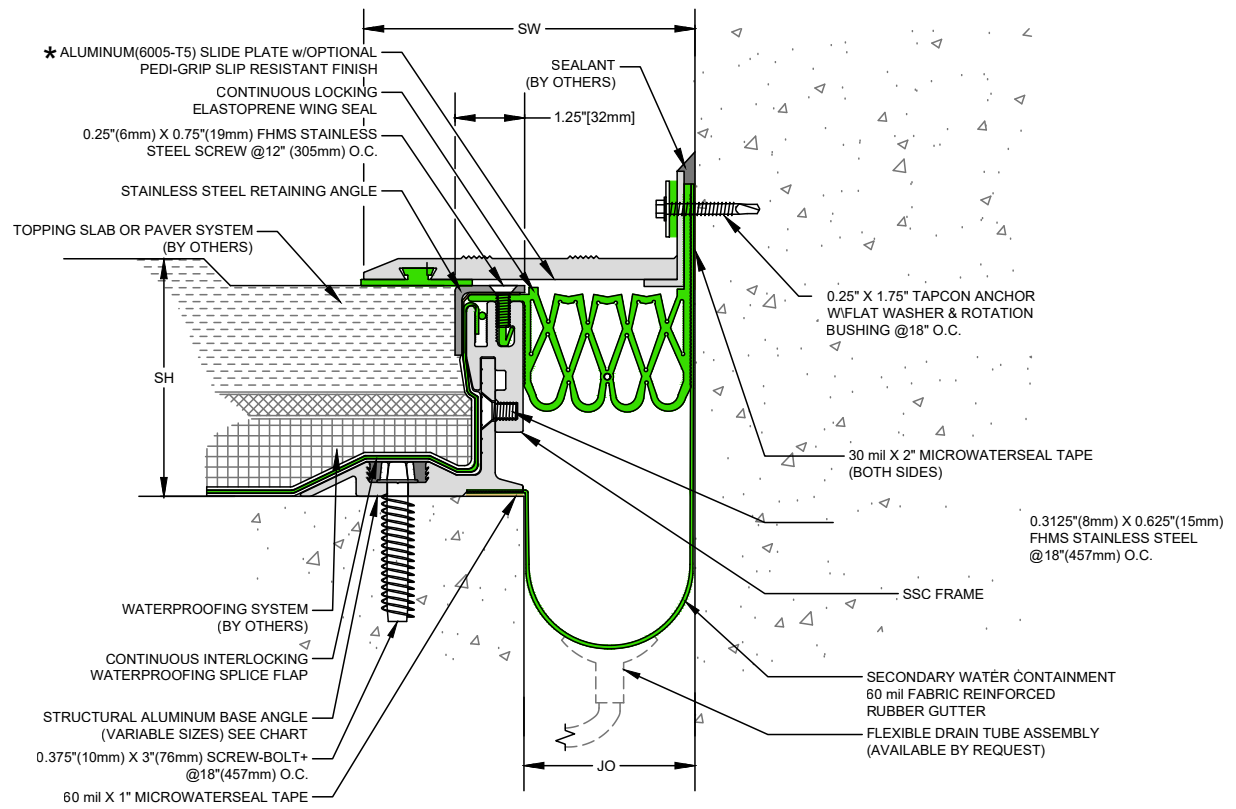

**RUBBER SEAL PROFILES**

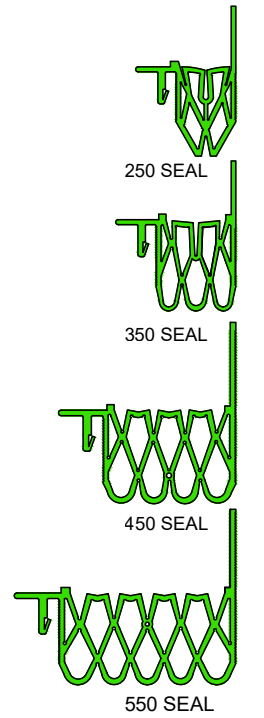

Base Angle Size	System Height (SH)	
<b>3.5 x 1.75</b>	<b>See Next Page</b>	
<b>3.5 x 2</b>	<b>3.25</b>	<b>83</b>
<b>3.5 x 2.25</b>	<b>3.5</b>	<b>89</b>
<b>3.5 x 2.5</b>	<b>3.75</b>	<b>95</b>
<b>3.5 x 2.75</b>	<b>4</b>	<b>102</b>
<b>3.5 x 3</b>	<b>4.25</b>	<b>108</b>
<b>3.5 x 3.25</b>	<b>4.5</b>	<b>114</b>
<b>3.5 x 3.5</b>	<b>4.75</b>	<b>121</b>
<b>3.5 x 3.75</b>	<b>5</b>	<b>127</b>
<b>3.5 x 4</b>	<b>5.25</b>	<b>133</b>
<b>3.5 x 4.25</b>	<b>5.5</b>	<b>140</b>
<b>3.5 x 4.5</b>	<b>5.75</b>	<b>146</b>
<b>3.5 x 4.75</b>	<b>6</b>	<b>152</b>

**SSC-C Vehicular Series Expansion Joint**  
(Slab-to-Wall)



50 MM WAY  
 PENDERGRASS, GA. 30567  
 706-824-7500 PHONE  
 800-241-3460 TOLL FREE  
 706-824-7501 FAX

[www.mm-usa.com](http://www.mm-usa.com)

For Spec-Data, Install Guides and other data visit [www.mm-usa.com](http://www.mm-usa.com)

**RIGHTS OF DESIGN**

All rights of design, detail, engineering and/or invention contained herein are the property of MM Systems Corporation and hereby reserved and are not to be reproduced or provided to any other party. MM Systems Corporation reserves the right to amend or withdraw any information contained herein without notice and will not be liable for any inaccuracy or ambiguity of said information.

**Split Slab Covered Membrane Expansion Joint**  
**SSC-C Vehicular Series**

Drawn by: <b>DMW</b>	Scale: <b>NTS</b>	Drawing Number: <b>41250-02</b>
SHT. 3 OF 4	Issue Date: <b>02-13-2019</b>	

Model Number	Nominal (JO <sub>N</sub> )		Slide Plate Width (SW <sub>N</sub> )		Thermal Movement (JO <sub>T</sub> )				Seismic Movement (JO <sub>S</sub> )				Total (JO <sub>T</sub> ) Movement	
	Minimum	Maximum	Minimum	Maximum	Minimum	Maximum	Minimum	Maximum	Minimum	Maximum	Minimum	Maximum		
SSC-C-250-P	<b>1.50</b>	8	<b>4.625</b>	117	<b>0.75</b>	19	<b>2.50</b>	64	<b>0.75</b>	19	<b>3.25</b>	83	<b>2.50</b>	64
SSC-C-350-P	<b>2.00</b>	57	<b>5.625</b>	143	<b>1.00</b>	25	<b>3.50</b>	89	<b>1.00</b>	25	<b>4.25</b>	108	<b>3.25</b>	83
SSC-C-450-P	<b>3.00</b>	76	<b>6.875</b>	175	<b>1.50</b>	38	<b>4.50</b>	114	<b>1.50</b>	38	<b>5.50</b>	140	<b>4.00</b>	102
SSC-C-550-P	<b>4.00</b>	102	<b>7.875</b>	200	<b>1.50</b>	38	<b>5.50</b>	140	<b>1.50</b>	38	<b>6.50</b>	165	<b>5.00</b>	127

Dimension shown in inches (bold) and millimeters. JO = Joint Opening, SL = Sight Line. Color Options for rubber seals are Black or Special Order Gray.

**Waterproofing Membrane Compatibility** - confirm with membrane manufacturer grade of rubber to be used on waterproofing splice flap.

**Elevation Tolerance** - Surface areas two feet on each side of the expansion joint opening shall have identical elevations creating flush slab-to-slab transition.

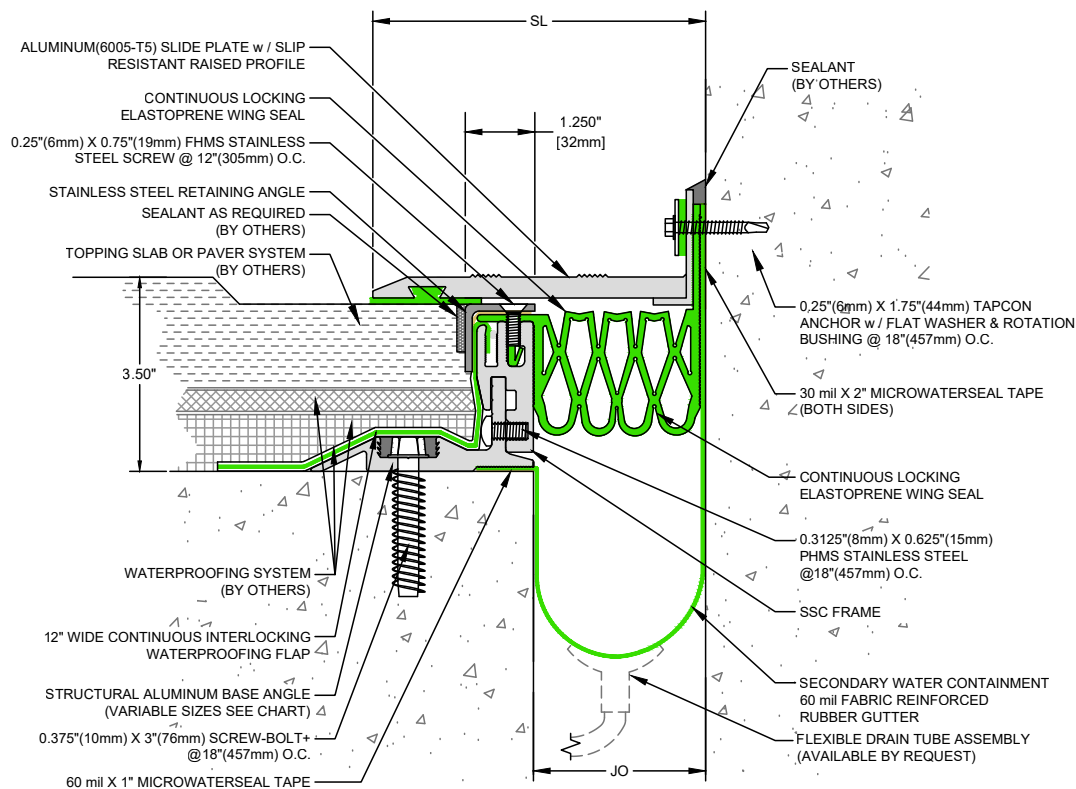

SSC-C Vehicular Series Expansion Joint / 3" System Height  
(Slab-to-Wall)

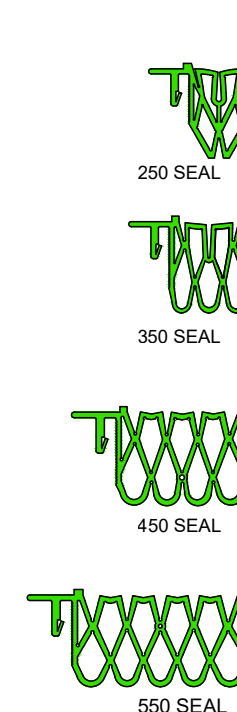

50 MM WAY  
PENDERGRASS, GA. 30567  
706-824-7500 PHONE  
800-241-3460 TOLL FREE  
706-824-7501 FAX

[www.mm-usa.com](http://www.mm-usa.com)

For Spec-Data, Install Guides and other data visit [www.mm-usa.com](http://www.mm-usa.com)

**RIGHTS OF DESIGN**

All rights of design, detail, engineering and/or invention contained herein are the property of MM Systems Corporation and hereby reserved and are not to be reproduced or provided to any other party. MM Systems Corporation reserves the right to amend or withdraw any information contained herein without notice and will not be liable for any inaccuracy or ambiguity of said information.

**Split Slab Covered Membrane Expansion Joint**

**SSC-C Vehicular Series 3" System Height**

Drawn by:  
DMW

Scale:  
NTS

Drawing Number:

SHT. 4 OF 4

Issue Date:  
02-13-2019

**41250-02**