

RUBBER SEAL PROFILES



250 SEAL



350 SEAL

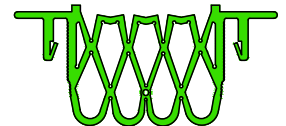

450 SEAL

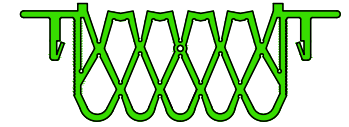

550 SEAL

Model Number	Nominal (JO _N)		Slide Plate Width (SW _N)		Thermal Movement (JO _T)		Seismic Movement (JO _S)		Total (JO _T)					
	Minimum	Maximum	Minimum	Maximum	Minimum	Maximum	Minimum	Maximum	Minimum	Maximum				
SSC-250-P	1.50	8	6.50	165	0.75	19	2.50	64	0.75	19	3.25	83	2.50	64
SSC-350-P	2.00	57	7.50	191	1.00	25	3.50	89	1.00	25	4.25	108	3.25	83
SSC-450-P	3.00	76	8.50	216	1.50	38	4.50	114	1.50	38	5.50	140	4.00	102
SSC-550-P	4.00	102	9.50	241	1.50	38	5.50	140	1.50	38	6.50	165	5.00	127

Dimension shown in inches (bold) and millimeters. JO = Joint Opening, SL = Sight Line. Color Options for rubber seals are Black or Special Order Gray.

Waterproofing Membrane Compatibility - confirm with membrane manufacturer grade of rubber to be used on waterproofing splice flap.

Elevation Tolerance - Surface areas two feet on each side of the expansion joint opening shall have identical elevations creating flush slab-to-slab transition.

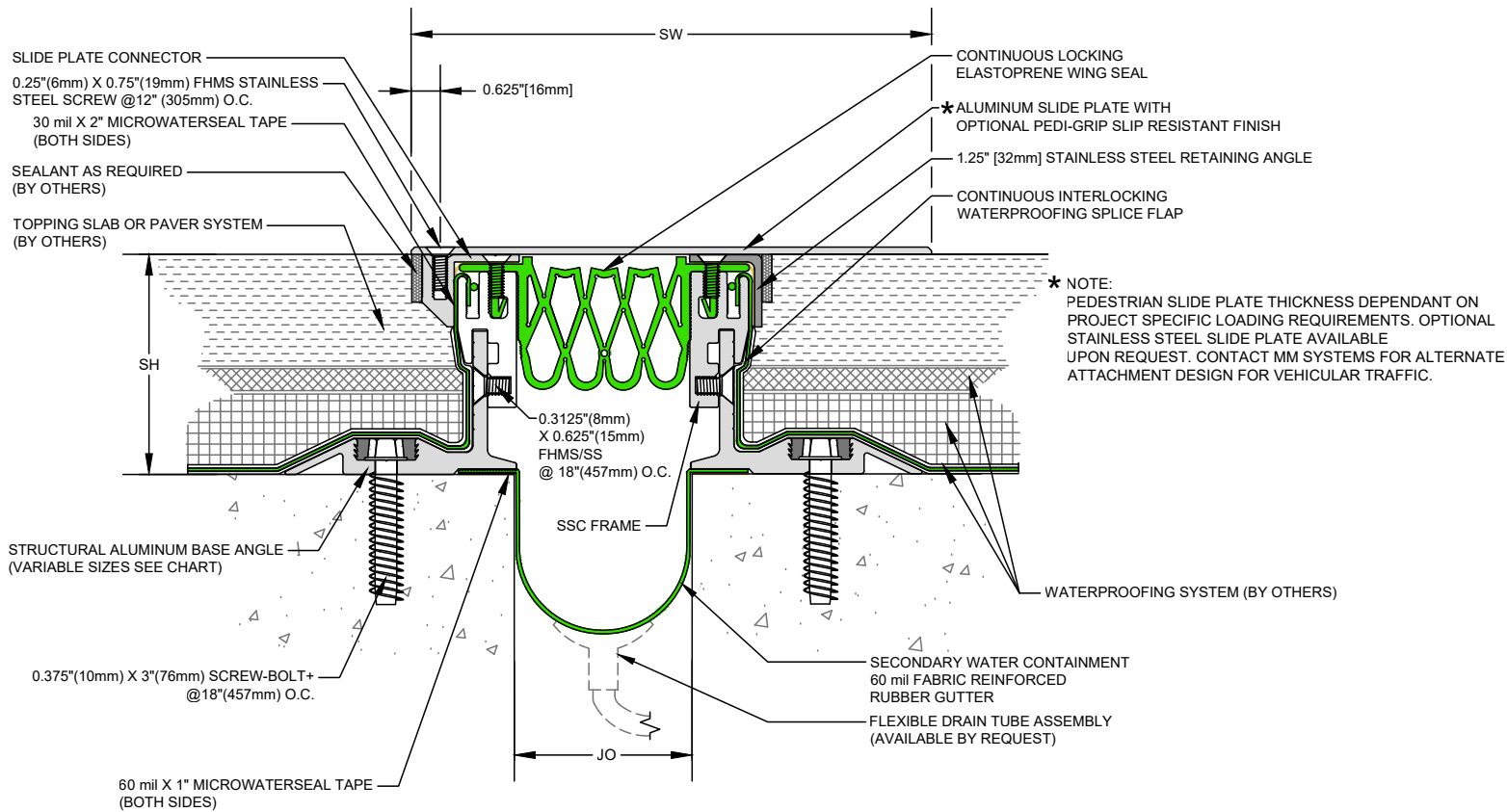

* NOTE: PEDESTRIAN SLIDE PLATE THICKNESS DEPENDANT ON PROJECT SPECIFIC LOADING REQUIREMENTS. OPTIONAL STAINLESS STEEL SLIDE PLATE AVAILABLE UPON REQUEST. CONTACT MM SYSTEMS FOR ALTERNATE ATTACHMENT DESIGN FOR VEHICULAR TRAFFIC.

SSC Pedestrian Series Expansion Joint
(Slab-to-Slab)

Base Angle Size	System Height (SH)	
3.5 x 1.75	See Next Page	
3.5 x 2	3.25	83
3.5 x 2.25	3.5	89
3.5 x 2.5	3.75	95
3.5 x 2.75	4	102
3.5 x 3	4.25	108
3.5 x 3.25	4.5	114
3.5 x 3.5	4.75	121
3.5 x 3.75	5	127
3.5 x 4	5.25	133
3.5 x 4.25	5.5	140
3.5 x 4.5	5.75	146
3.5 x 4.75	6	152



50 MM WAY
PENDERGRASS, GA. 30567
706-824-7500 PHONE
800-241-3460 TOLL FREE
706-824-7501 FAX

www.mm-usa.com

For Spec-Data, Install Guides and other data visit www.mm-usa.com

RIGHTS OF DESIGN

All rights of design, detail, engineering and/or invention contained herein are the property of MM Systems Corporation and hereby reserved and are not to be reproduced or provided to any other party. MM Systems Corporation reserves the right to amend or withdraw any information contained herein without notice and will not be liable for any inaccuracy or ambiguity of said information.

Split Slab Covered Membrane Expansion Joint

SSC Pedestrian Series

Drawn by: DMW	Scale: NTS	Drawing Number: 41250-01
SHT. 1 OF 4	Issue Date: 02-13-2019	

Model Number	Nominal (JO _n)		Slide Plate Width (SW _n)		Thermal Movement (IO _t)				Seismic Movement (IO _s)				Total (IO _{t,s}) Movement	
	Minimum	Maximum	Minimum	Maximum	Minimum	Maximum	Minimum	Maximum	Minimum	Maximum	Minimum	Maximum		
SSC-250-P	1.50	8	6.50	165	0.75	19	2.50	64	0.75	19	3.25	83	2.50	64
SSC-350-P	2.00	57	7.50	191	1.00	25	3.50	89	1.00	25	4.25	108	3.25	83
SSC-450-P	3.00	76	8.50	216	1.50	38	4.50	114	1.50	38	5.50	140	4.00	102
SSC-550-P	4.00	102	9.50	241	1.50	38	5.50	140	1.50	38	6.50	165	5.00	127

Dimension shown in inches (bold) and millimeters. JO = Joint Opening. SL = Sight Line. Color Options for rubber seals are Black or Special Order Gray.

Waterproofing Membrane Compatibility - confirm with membrane manufacturer grade of rubber to be used on waterproofing splice flap.

Elevation Tolerance - Surface areas two feet on each side of the expansion joint opening shall have identical elevations creating flush slab-to-slab transition.

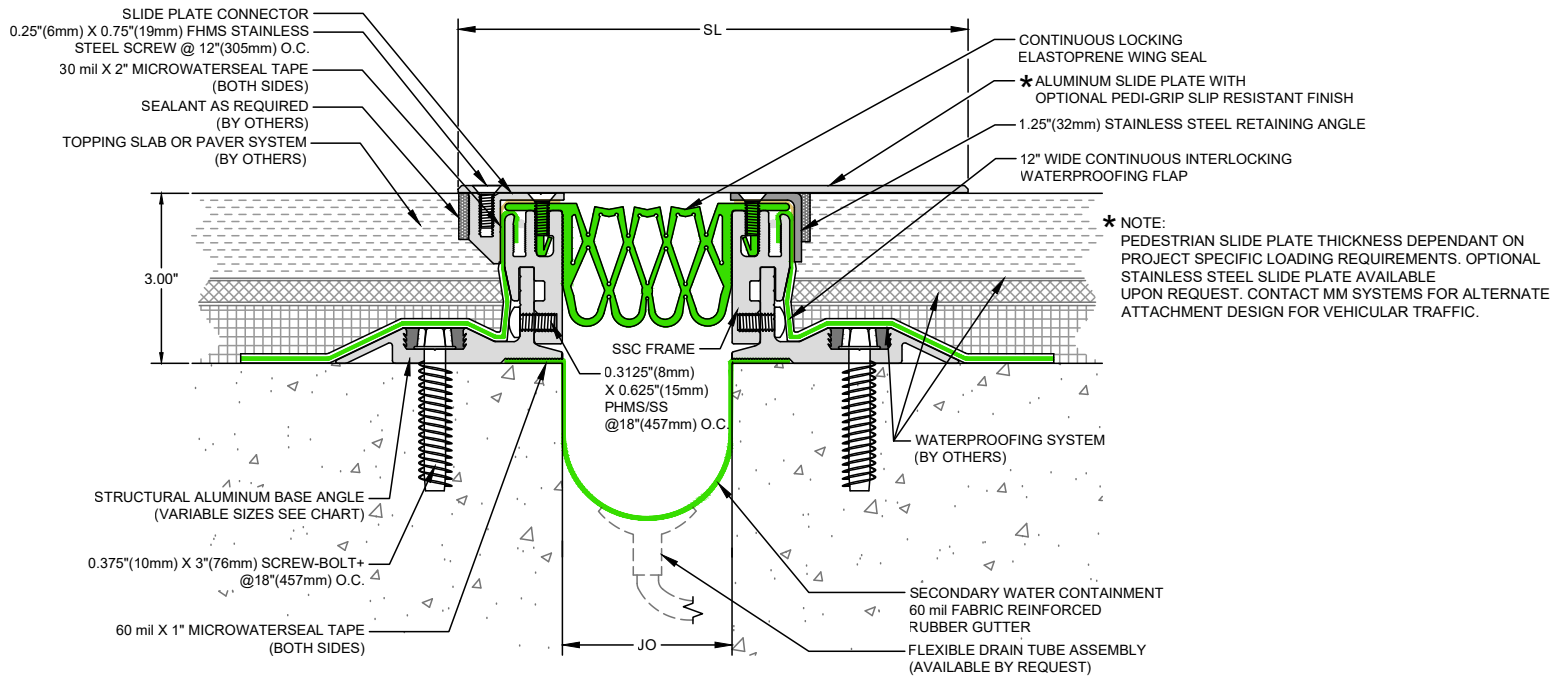

SSC Series Expansion Joint / 3" System Height
(Slab-to-Slab)



250 SEAL



350 SEAL

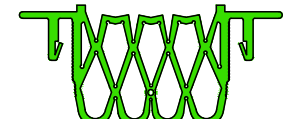

450 SEAL



550 SEAL



50 MM WAY
PENDERGRASS, GA. 30567
706-824-7500 PHONE
800-241-3460 TOLL FREE
706-824-7501 FAX

www.mm-usa.com

For Spec-Data, Install Guides and other data visit www.mm-usa.com

RIGHTS OF DESIGN

All rights of design, detail, engineering and/or invention contained herein are the property of MM Systems Corporation and hereby reserved and are not to be reproduced or provided to any other party. MM Systems Corporation reserves the right to amend or withdraw any information contained herein without notice and will not be liable for any inaccuracy or ambiguity of said information.

Split Slab Covered Membrane Expansion Joint
SSC Pedestrian Series 3" System Height

Drawn by:
DMW

Scale:
NTS

Drawing Number:

SHT. 2 OF 4

Issue Date:
02-13-2019

41250-01

Model Number	Nominal (JO _N)		Slide Plate Width (SW _N)		Thermal Movement (JO _T)				Seismic Movement (JO _S)				Total (JO _A)	
	Minimum	Maximum	Minimum	Maximum	Minimum	Maximum	Minimum	Maximum	Minimum	Maximum	Minimum	Maximum		
SSC-250-V	1.50	8	7.00	178	0.75	19	2.50	64	0.75	19	3.25	83	2.50	64
SSC-350-V	2.00	57	8.00	203	1.00	25	3.50	89	1.00	25	4.25	108	3.25	83
SSC-450-V	3.00	76	9.25	235	1.50	38	4.50	114	1.50	38	5.50	140	4.00	102
SSC-550-V	4.00	102	10.25	260	1.50	38	5.50	140	1.50	38	6.50	165	5.00	127

Dimension shown in inches (bold) and millimeters. JO = Joint Opening. SL = Sight Line. Color Options for rubber seals are Black or Special Order Gray.

Waterproofing Membrane Compatibility - confirm with membrane manufacturer grade of rubber to be used on waterproofing splice flap.

Elevation Tolerance - Surface areas two feet on each side of the expansion joint opening shall have identical elevations creating flush slab-to-slab transition.

RUBBER SEAL PROFILES



250 SEAL



350 SEAL



450 SEAL

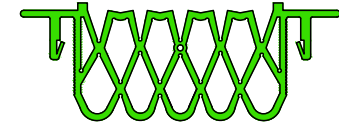

550 SEAL

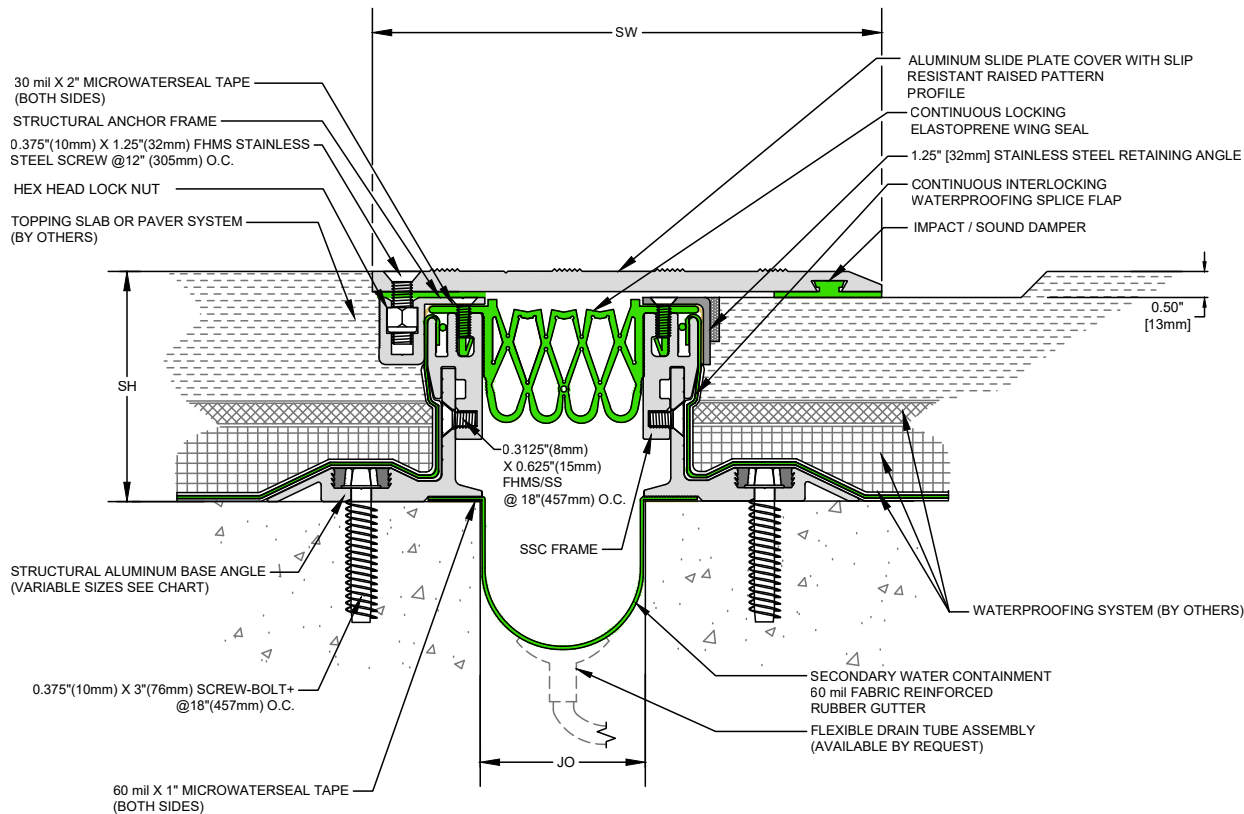

SSC Vehicular Series Expansion Joint
(Slab-to-Slab)

Base Angle Size	System Height (SH)	
3.5 x 1.75	See Next Page	
3.5 x 2	3.25	83
3.5 x 2.25	3.5	89
3.5 x 2.5	3.75	95
3.5 x 2.75	4	102
3.5 x 3	4.25	108
3.5 x 3.25	4.5	114
3.5 x 3.5	4.75	121
3.5 x 3.75	5	127
3.5 x 4	5.25	133
3.5 x 4.25	5.5	140
3.5 x 4.5	5.75	146
3.5 x 4.75	6	152



50 MM WAY
PENDERGRASS, GA. 30567
706-824-7500 PHONE
800-241-3460 TOLL FREE
706-824-7501 FAX

www.mm-usa.com

For Spec-Data, Install Guides and other data visit www.mm-usa.com

RIGHTS OF DESIGN

All rights of design, detail, engineering and/or invention contained herein are the property of MM Systems Corporation and hereby reserved and are not to be reproduced or provided to any other party. MM Systems Corporation reserves the right to amend or withdraw any information contained herein without notice and will not be liable for any inaccuracy or ambiguity of said information.

Split Slab Covered Membrane Expansion Joint

SSC Vehicular Series

Drawn by: DMW	Scale: NTS	Drawing Number: 41250-01
SHT. 3 OF 4	Issue Date: 02-13-2019	

Model Number	Nominal (JO _N)		Slide Plate Width (SW _N)		Thermal Movement (JO _T)				Seismic Movement (JO _S)				Total (JO _T) Movement	
	Minimum	Maximum	Minimum	Maximum	Minimum	Maximum	Minimum	Maximum	Minimum	Maximum	Minimum	Maximum		
SSC-250-P	1.50	8	6.50	165	0.75	19	2.50	64	0.75	19	3.25	83	2.50	64
SSC-350-P	2.00	57	7.50	191	1.00	25	3.50	89	1.00	25	4.25	108	3.25	83
SSC-450-P	3.00	76	8.50	216	1.50	38	4.50	114	1.50	38	5.50	140	4.00	102
SSC-550-P	4.00	102	9.50	241	1.50	38	5.50	140	1.50	38	6.50	165	5.00	127

Dimension shown in inches (bold) and millimeters. JO = Joint Opening, SL = Sight Line. Color Options for rubber seals are Black or Special Order Gray.

Waterproofing Membrane Compatibility - confirm with membrane manufacturer grade of rubber to be used on waterproofing splice flap.

Elevation Tolerance - Surface areas two feet on each side of the expansion joint opening shall have identical elevations creating flush slab-to-slab transition.

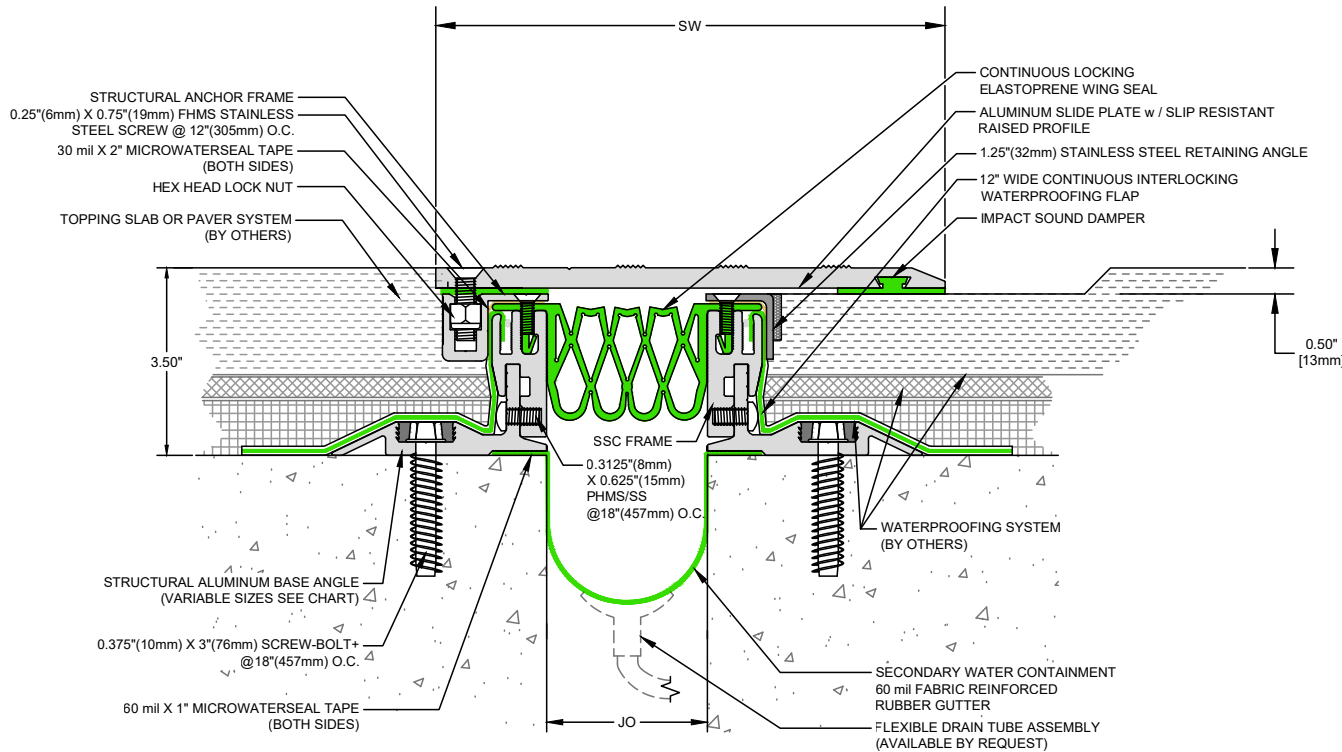

SSC Vehicular Series Expansion Joint / 3" System Height
(Slab-to-Slab)

RUBBER SEAL PROFILES



250 SEAL



350 SEAL

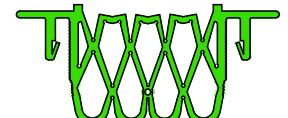

450 SEAL

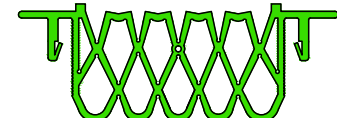

550 SEAL



50 MM WAY
PENDERGRASS, GA. 30567
706-824-7500 PHONE
800-241-3460 TOLL FREE
706-824-7501 FAX

www.mm-usa.com

For Spec-Data, Install Guides and other data visit www.mm-usa.com

RIGHTS OF DESIGN

All rights of design, detail, engineering and/or invention contained herein are the property of MM Systems Corporation and hereby reserved and are not to be reproduced or provided to any other party. MM Systems Corporation reserves the right to amend or withdraw any information contained herein without notice and will not be liable for any inaccuracy or ambiguity of said information.

Split Slab Covered Membrane Expansion Joint

SSC Vehicular Series 3" System Height

Drawn by:
DMW

Scale:
NTS

Drawing Number:

SHT. 4 OF 4

Issue Date:
02-13-2019

41250-01