

RUBBER SEAL PROFILES

Model Number	Nominal (JO _N)		Slide Plate Width (SW _N)		Thermal Movement (JO _T)				Seismic Movement (JO _S)				Total (JO _T) Movement	
	Minimum	Maximum	Minimum	Maximum	Minimum	Maximum	Minimum	Maximum	Minimum	Maximum	Minimum	Maximum	Minimum	Maximum
SSC-250-P	1.50	8	6.50	165	0.75	19	2.50	64	0.75	19	3.25	83	2.50	64
SSC-350-P	2.00	57	7.50	191	1.00	25	3.50	89	1.00	25	4.25	108	3.25	83
SSC-450-P	3.00	76	8.50	216	1.50	38	4.50	114	1.50	38	5.50	140	4.00	102
SSC-550-P	4.00	102	9.50	241	1.50	38	5.50	140	1.50	38	6.50	165	5.00	127

Dimension shown in inches (bold) and millimeters. JO = Joint Opening, SL = Sight Line. Color Options for rubber seals are Black or Special Order Gray.

Waterproofing Membrane Compatibility - confirm with membrane manufacturer grade of rubber to be used on waterproofing splice flap.

Elevation Tolerance- Surface areas two feet on each side of the expansion joint opening shall have identical elevations creating flush slab-to-slab transition.

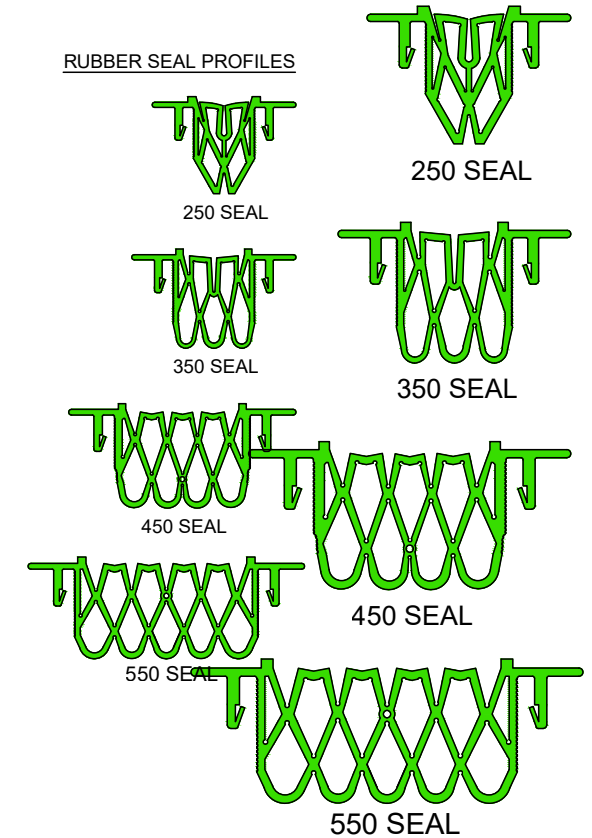
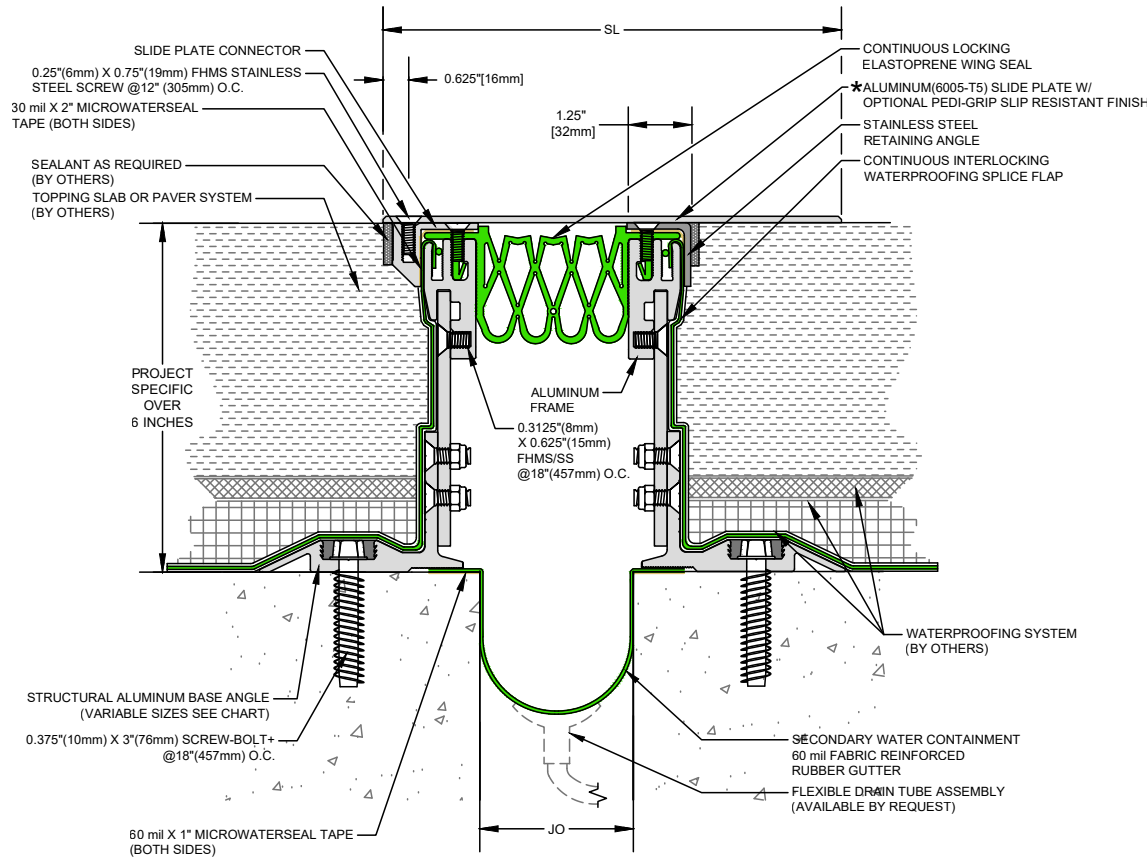

SSC Pedestrian Series Adjustable Height Expansion Joint
(Slab-to-Slab)



50 MM WAY
PENDERGRASS, GA. 30567
706-824-7500 PHONE
800-241-3460 TOLL FREE
706-824-7501 FAX

www.mm-usa.com

For Spec-Data, Install Guides and other data visit www.mm-usa.com

RIGHTS OF DESIGN

All rights of design, detail, engineering and/or invention contained herein are the property of MM Systems Corporation and hereby reserved and are not to be reproduced or provided to any other party. MM Systems Corporation reserves the right to amend or withdraw any information contained herein without notice and will not be liable for any inaccuracy or ambiguity of said information.

Split Slab Covered Membrane Expansion Joint

SSC Pedestrian Series / Adjustable Height

Drawn by:
DMW

Scale:
NTS

Drawing Number:

SHT. 1 OF 2

Issue Date:
02-13-2019

41250-06

Model Number	Nominal (JO _N)		Slide Plate Width (SW _N)		Thermal Movement (JO _T)				Seismic Movement (JO _S)				Total (JO _T) Movement	
	Minimum	Maximum	Minimum	Maximum	Minimum	Maximum	Minimum	Maximum	Minimum	Maximum	Minimum	Maximum		
SSC-250-V	1.50	8	7.00	178	0.75	19	2.50	64	0.75	19	3.25	83	2.50	64
SSC-350-V	2.00	57	8.00	203	1.00	25	3.50	89	1.00	25	4.25	108	3.25	83
SSC-450-V	3.00	76	9.25	235	1.50	38	4.50	114	1.50	38	5.50	140	4.00	102
SSC-550-V	4.00	102	10.25	260	1.50	38	5.50	140	1.50	38	6.50	165	5.00	127

Dimension shown in inches (bold) and millimeters. JO = Joint Opening, SL = Sight Line. Color Options for rubber seals are Black or Special Order Gray.

Waterproofing Membrane Compatibility - confirm with membrane manufacturer grade of rubber to be used on waterproofing splice flap.

Elevation Tolerance - Surface areas two feet on each side of the expansion joint opening shall have identical elevations creating flush slab-to-slab transition.

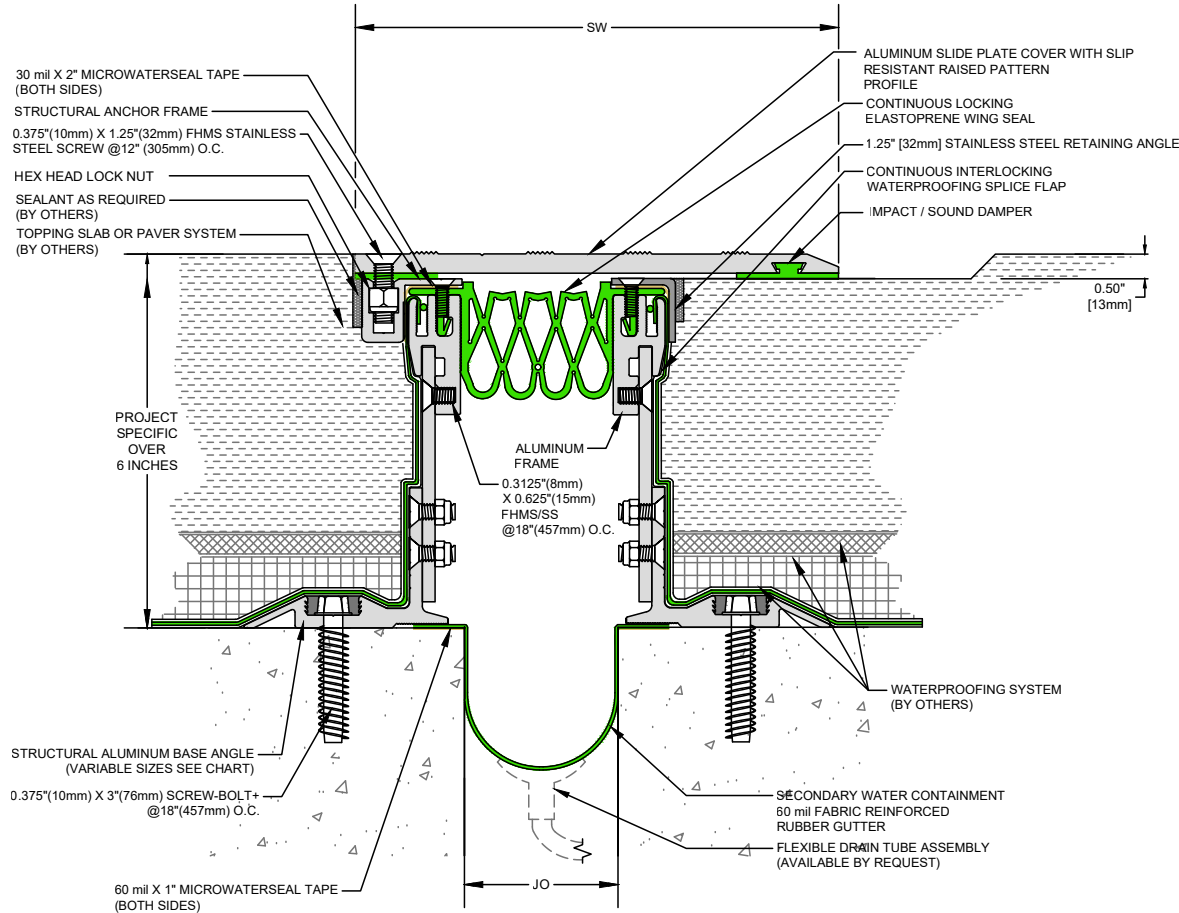

SSC Vehicular Series Adjustable Height Expansion Joint
(Slab-to-Slab)

RUBBER SEAL PROFILES

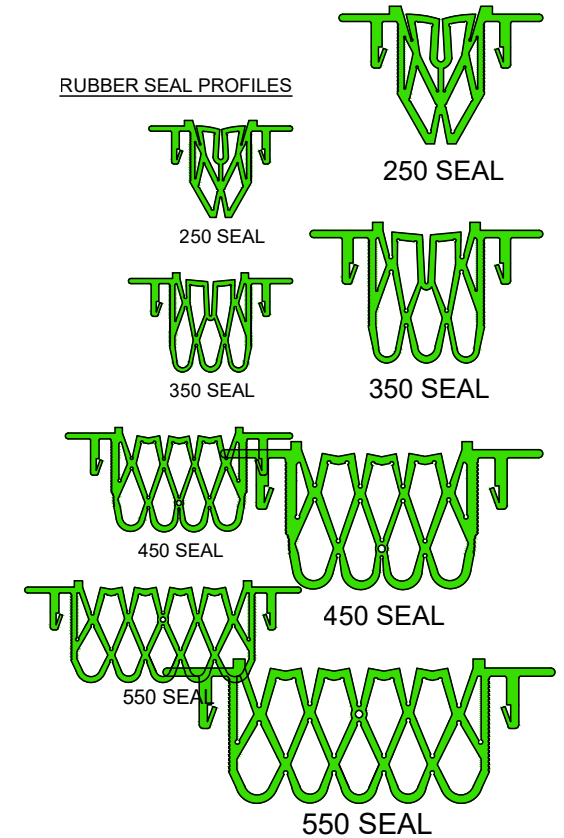

50 MM WAY
PENDERGRASS, GA. 30567
706-824-7500 PHONE
800-241-3460 TOLL FREE
706-824-7501 FAX

www.mm-usa.com

For Spec-Data, Install Guides and other data visit www.mm-usa.com

RIGHTS OF DESIGN

All rights of design, detail, engineering and/or invention contained herein are the property of MM Systems Corporation and hereby reserved and are not to be reproduced or provided to any other party. MM Systems Corporation reserves the right to amend or withdraw any information contained herein without notice and will not be liable for any inaccuracy or ambiguity of said information.

Split Slab Covered Membrane Expansion Joint
SSC Vehicular Series / Adjustable Height

Drawn by:
DMW

Scale:
NTS

Drawing Number:

SHT. 2 OF 2

Issue Date:
02-13-2019

41250-06