

**UL**  
LISTING DESIGN  
(see page 2 chart)

**IMPORTANT LIFE SAFETY PRODUCT NOTE**  
3-HOUR FOAM SEAL FIRE BARRIER MUST BE INSTALLED IN A PROPERLY CONSTRUCTED 3-HOUR RATED WALL ASSEMBLY WITH A MINIMUM WALL THICKNESS OF 4.5-INCHES AT THE JOINT FACE. BARRIERS MUST BE INSTALLED IN STRICT ACCORDANCE WITH MM SYSTEMS PRODUCT INSTALLATION INSTRUCTIONS. CONTRACTOR MUST VERIFY PRIOR TO FABRICATION.

**SIF-FR-3S Series**  
**3 Hour Fire Rated Expansion Joint**  
**Wall-to-Wall (Single Side Silicone)**

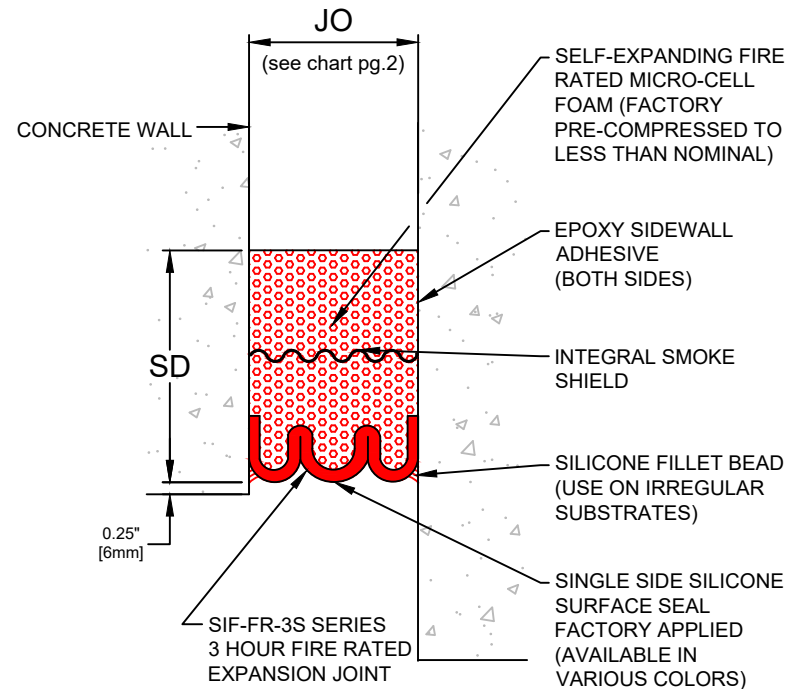

**UL**  
LISTING DESIGN  
(see page 2 chart)

**IMPORTANT LIFE SAFETY PRODUCT NOTE**  
3-HOUR FOAM SEAL FIRE BARRIER MUST BE INSTALLED IN A PROPERLY CONSTRUCTED 3-HOUR RATED WALL ASSEMBLY WITH A MINIMUM WALL THICKNESS OF 4.5-INCHES AT THE JOINT FACE. BARRIERS MUST BE INSTALLED IN STRICT ACCORDANCE WITH MM SYSTEMS PRODUCT INSTALLATION INSTRUCTIONS. CONTRACTOR MUST VERIFY PRIOR TO FABRICATION.

**SIF-FR-3S Series**  
**3 Hour Fire Rated Expansion Joint**  
**Wall-to-Corner (Single Side Silicone)**



50 MM WAY  
PENDERGRASS, GA. 30567  
706-824-7500 PHONE  
800-241-3460 TOLL FREE  
706-824-7501 FAX

[www.mm.systems](http://www.mm.systems)

For Spec-Data, Install Guides, and other data visit [www.mm-usa.com](http://www.mm-usa.com)

**RIGHTS OF DESIGN**

All rights of design, detail, engineering and/or invention contained herein are the property of MM Systems and hereby reserved and are not to be reproduced or provided to any other party. MM Systems reserves the right to amend or withdraw any information contained herein without notice and will not be liable for any inaccuracy or ambiguity of said information.

**Silicone Impregnated Foam - 3 Hour Fire Rated Expansion Joint**

**SIF-FR-3S Series**

Drawn by: MVP	Scale: NTS	Drawing Number:
SHT. 1 OF 2	Issue Date: 11/20/2020	<b>30753-01</b>

## (SIF-FR-3S) FIRE RATED SERIES EXPANSION JOINT MOVEMENT CHART

Model Number	UL Listing	Joint Opening (JO <sup>N</sup> )		Thermal / Seismic Movement (JO <sup>T</sup> )				Total (JO <sup>A</sup> )		Lateral Shear		Vertical Displacement		Seal Depth (SD)	
		Nominal		Minimum		Maximum		Movement							
SIF-FR-050-3S	WW-D-0254	<b>0.50</b>	13	<b>0.250</b>	6	<b>0.750</b>	19	<b>0.50</b>	13	<b>0.50</b>	13	<b>0.50</b>	13	<b>4.00</b>	102
SIF-FR-063-3S	WW-D-0254	<b>0.63</b>	16	<b>0.315</b>	8	<b>0.945</b>	24	<b>0.63</b>	16	<b>0.63</b>	16	<b>0.63</b>	16	<b>4.00</b>	102
SIF-FR-075-3S	WW-D-0254	<b>0.75</b>	19	<b>0.375</b>	10	<b>1.125</b>	29	<b>0.75</b>	19	<b>0.75</b>	19	<b>0.75</b>	19	<b>4.00</b>	102
SIF-FR-100-3S	WW-D-0254	<b>1.00</b>	25	<b>0.500</b>	13	<b>1.500</b>	38	<b>1.00</b>	25	<b>1.00</b>	25	<b>1.00</b>	25	<b>4.00</b>	102
SIF-FR-125-3S	WW-D-0254	<b>1.25</b>	32	<b>0.625</b>	16	<b>1.875</b>	48	<b>1.25</b>	32	<b>1.25</b>	32	<b>1.25</b>	32	<b>4.00</b>	102
SIF-FR-150-3S	WW-D-0254	<b>1.50</b>	38	<b>0.750</b>	19	<b>2.250</b>	57	<b>1.50</b>	38	<b>1.50</b>	38	<b>1.50</b>	38	<b>4.00</b>	102
SIF-FR-175-3S	WW-D-0254	<b>1.75</b>	44	<b>0.875</b>	22	<b>2.625</b>	67	<b>1.75</b>	44	<b>1.75</b>	44	<b>1.75</b>	44	<b>4.00</b>	102
SIF-FR-200-3S	WW-D-1229	<b>2.00</b>	51	<b>1.000</b>	25	<b>3.000</b>	76	<b>2.00</b>	51	<b>2.00</b>	51	<b>2.00</b>	51	<b>4.00</b>	102
SIF-FR-225-3S	WW-D-1229	<b>2.25</b>	57	<b>1.125</b>	29	<b>3.375</b>	86	<b>2.25</b>	57	<b>2.25</b>	57	<b>2.25</b>	57	<b>4.00</b>	102
SIF-FR-250-3S	WW-D-1229	<b>2.50</b>	64	<b>1.250</b>	32	<b>3.750</b>	95	<b>2.50</b>	64	<b>2.50</b>	64	<b>2.50</b>	64	<b>4.00</b>	102
SIF-FR-275-3S	WW-D-1229	<b>2.75</b>	70	<b>1.375</b>	35	<b>4.125</b>	105	<b>2.75</b>	70	<b>2.75</b>	70	<b>2.75</b>	70	<b>4.00</b>	102
SIF-FR-300-3S	WW-D-1229	<b>3.00</b>	76	<b>1.500</b>	38	<b>4.500</b>	114	<b>3.00</b>	76	<b>3.00</b>	76	<b>3.00</b>	76	<b>4.00</b>	102

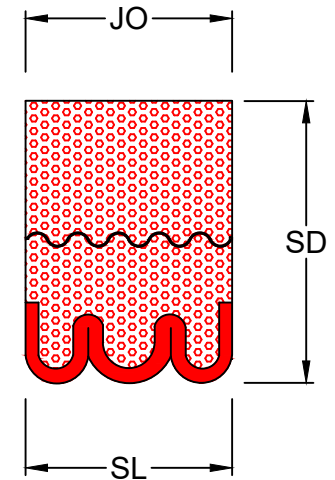

SINGLE SIDE  
SILICONE

Dimension shown in **inches (bold)** and millimeters.

Please note that Joint Opening (JO) and Sight Line (SL) are one in the same for the SIF-FR Series.

For use only in concrete wall applications.

[Note: Refer to the SIF-FR-3S AutoCAD file for individual seal drawings.](#)



50 MM WAY  
PENDERGRASS, GA. 30567  
706-824-7500 PHONE  
800-241-3460 TOLL FREE  
706-824-7501 FAX

[www.mm.systems](http://www.mm.systems)

For Spec-Data, Install Guides, and other data visit [www.mm-usa.com](http://www.mm-usa.com)

### RIGHTS OF DESIGN

All rights of design, detail, engineering and/or invention contained herein are the property of MM Systems and hereby reserved and are not to be reproduced or provided to any other party. MM Systems reserves the right to amend or withdraw any information contained herein without notice and will not be liable for any inaccuracy or ambiguity of said information.

### Silicone Impregnated Foam - 3 Hour Fire Rated Expansion Joint SIF-FR-3S Series

Drawn by:  
MVP

Scale:  
NTS

Drawing Number:

SHT. 2 OF 2

Issue Date:  
11/20/2020

**30753-02**