

**EIS-Plus Series Expansion Joint  
(Slab-to-Slab)**

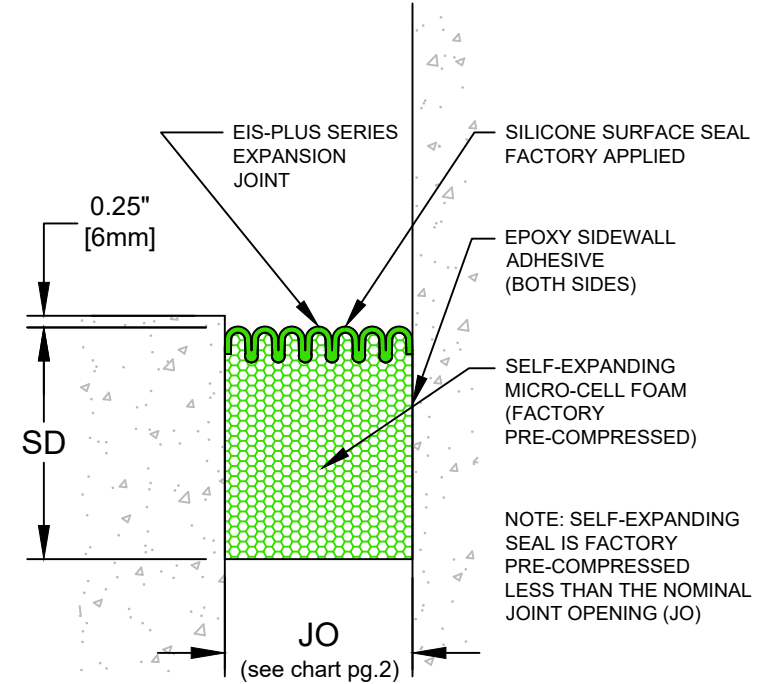

**EIS-Plus Series Expansion Joint  
(Slab-to-Wall)**



50 MM WAY  
PENDERGRASS, GA. 30567  
706-824-7500 PHONE  
800-241-3460 TOLL FREE  
706-824-7501 FAX

[www.mm.systems](http://www.mm.systems)

For Spec-Data, Install Guides, and other data visit [www.mm-usa.com](http://www.mm-usa.com)

**RIGHTS OF DESIGN**

All rights of design, detail, engineering and/or invention contained herein are the property of MM Systems and hereby reserved and are not to be reproduced or provided to any other party. MM Systems reserves the right to amend or withdraw any information contained herein without notice and will not be liable for any inaccuracy or ambiguity of said information.

**Expanding Impregnated Seal Expansion Joint  
EIS-Plus Series**

Drawn by: MVP	Scale: NTS	Drawing Number:  <b>31651-01</b>
SHT. 1 OF 2	Issue Date: 11/20/2020	

## EIS-PLUS SERIES EXPANSION JOINT MOVEMENT CHART

Model Number	Joint Opening (JO <sup>N</sup> )		Sight Line (SL <sup>N</sup> )		Thermal / Seismic Movement (JO <sup>T</sup> )				Total (JO <sup>A</sup> )		Lateral Shear		Vertical Displacement		Seal Depth (SD)	
	Nominal		Nominal		Minimum		Maximum		Movement							
EIS-200+	<b>2.00</b>	51	<b>2.00</b>	51	<b>1.000</b>	25	<b>3.000</b>	76	<b>2.00</b>	51	<b>2.00</b>	51	<b>2.00</b>	51	<b>3.00</b>	76
EIS-225+	<b>2.25</b>	57	<b>2.25</b>	57	<b>1.125</b>	29	<b>3.375</b>	86	<b>2.25</b>	57	<b>2.25</b>	57	<b>2.25</b>	57	<b>3.00</b>	76
EIS-250+	<b>2.50</b>	64	<b>2.50</b>	64	<b>1.250</b>	32	<b>3.750</b>	95	<b>2.50</b>	64	<b>2.50</b>	64	<b>2.50</b>	64	<b>3.00</b>	76
EIS-275+	<b>2.75</b>	70	<b>2.75</b>	70	<b>1.375</b>	35	<b>4.125</b>	105	<b>2.75</b>	70	<b>2.75</b>	70	<b>2.75</b>	70	<b>3.00</b>	76
EIS-300+	<b>3.00</b>	76	<b>3.00</b>	76	<b>1.500</b>	38	<b>4.500</b>	114	<b>3.00</b>	76	<b>3.00</b>	76	<b>3.00</b>	76	<b>3.00</b>	76
EIS-325+	<b>3.25</b>	83	<b>3.25</b>	83	<b>1.625</b>	41	<b>4.875</b>	124	<b>3.25</b>	83	<b>3.25</b>	83	<b>3.25</b>	83	<b>3.00</b>	76
EIS-350+	<b>3.50</b>	89	<b>3.50</b>	89	<b>1.750</b>	44	<b>5.250</b>	133	<b>3.50</b>	89	<b>3.50</b>	89	<b>3.50</b>	89	<b>3.00</b>	76
EIS-375+	<b>3.75</b>	95	<b>3.75</b>	95	<b>1.875</b>	48	<b>5.625</b>	143	<b>3.75</b>	95	<b>3.75</b>	95	<b>3.75</b>	95	<b>3.00</b>	76
EIS-400+	<b>4.00</b>	102	<b>4.00</b>	102	<b>2.000</b>	51	<b>6.000</b>	152	<b>4.00</b>	102	<b>4.00</b>	102	<b>4.00</b>	102	<b>4.00</b>	102

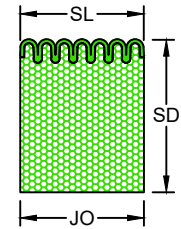

SINGLE SIDE SILICONE

Dimension shown in **inches** (bold) and millimeters. Contact MM Systems for larger system sizes.

Cover plates are available as an option to protect the foam seals but are not mandatory.

**Refer to the EIS-Plus AutoCAD file for individual seal drawings.**



50 MM WAY  
 PENDERGRASS, GA. 30567  
 706-824-7500 PHONE  
 800-241-3460 TOLL FREE  
 706-824-7501 FAX

www.mm.systems

For Spec-Data, Install Guides, and other data visit [www.mm-usa.com](http://www.mm-usa.com)

**RIGHTS OF DESIGN**

All rights of design, detail, engineering and/or invention contained herein are the property of MM Systems and hereby reserved and are not to be reproduced or provided to any other party. MM Systems reserves the right to amend or withdraw any information contained herein without notice and will not be liable for any inaccuracy or ambiguity of said information.

### Expanding Impregnated Seal Expansion Joint

## EIS-Plus Series

Drawn by: <b>MVP</b>	Scale: <b>NTS</b>	Drawing Number: <b>31651-02</b>
SHT. 2 OF 2	Issue Date: 11/20/2020	